

EUROPEAN M12 SHOWER TRAY KIT

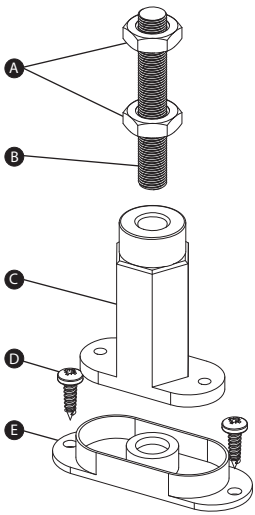

| Item | Description | 6 Pack Qty | 9 Pack Qty |
|------|-------------------------|------------|------------|
| A | M12 Locking Nuts | 12 | 18 |
| B | 60mm M12 Threaded Bar | 6 | 9 |
| C | M12 Foot | 6 | 9 |
| D | 5/8" Pan Head Screws | 12 | 18 |
| E | M12 Foot Locating Plate | 6 | 9 |

STEP 1

Carefully using the fittings provided assemble the leg kits onto the shower tray as shown opposite.

With the leg kits in position, position the tray as required the correct way up and adjust the height of the leg kits to ensure the tray is level.

Lock the legs into position using the M12 locking nuts **A**

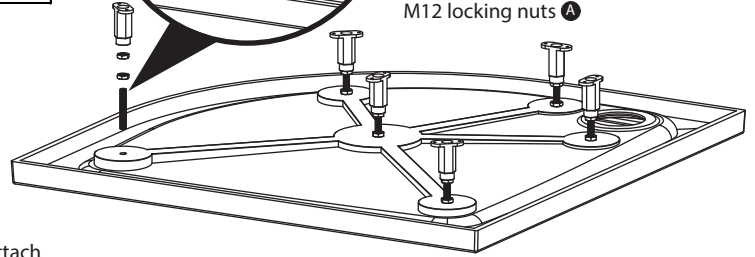
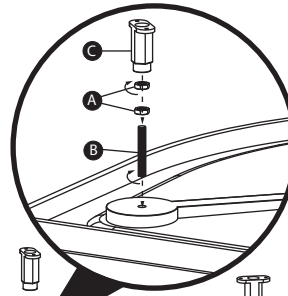

STEP 2

Carefully turn the tray back over and attach the M12 foot locating plates **E** onto all of the M12 feet. This is done by carefully pushing them into position as shown.

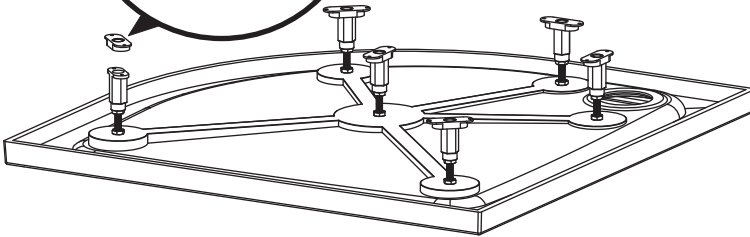
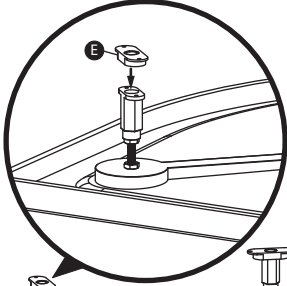

STEP 3

Apply a good quality adhesive or double sided adhesive tape to the face of the M12 foot locating plates as shown.

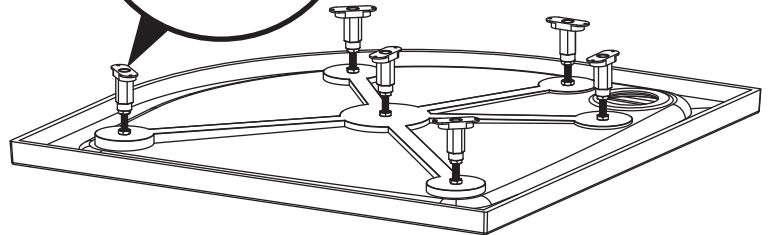
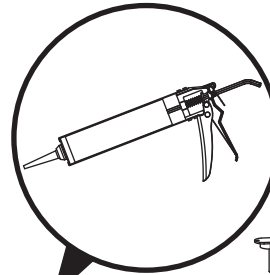

STEP 4

Carefully lift the tray the correct way up and place in the required position. If you have used adhesive, allow this to fully cure before moving onto the next step.

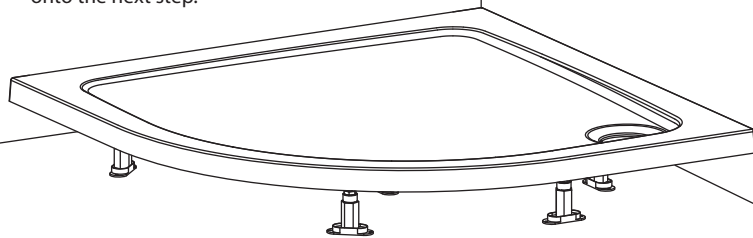

STEP 5

If you have used adhesive to secure the M12 foot plates, wait until this is cured. Carefully lift the tray clear of the foot plates. Securely fix the foot plates into position by using 2x 5/8" screws on each plate.

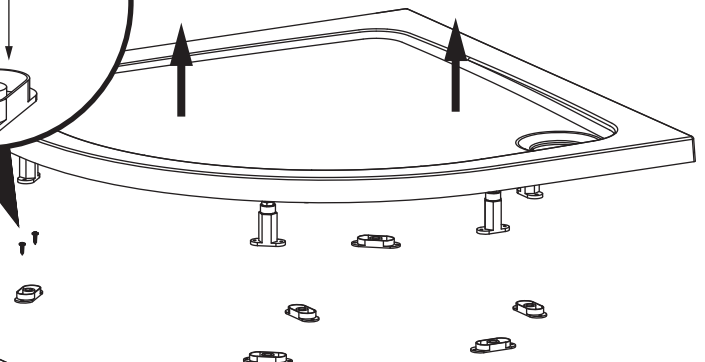
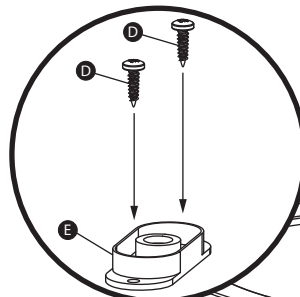

STEP 6

Carefully place the tray back in the required position ensuring the feet locate with the feet locating plates. Check that the tray is level and adjust if necessary.

