

Important – Please Read

Important - please read

Please read these instructions carefully before starting installation and keep for future reference.

Remove all packaging and check the product for missing parts or damage before starting installation.

Any alterations made to this product and fittings may infringe water regulations and will invalidate the guarantee.

The installation must comply with all Local/National Water Supply Authority Regulations/Byelaws and Building and Plumbing (UK:BS6700) Regulations.

We strongly recommend that you use a qualified and registered plumber.

Installer must comply with current regulations.

Please note if installing in an enclosed environment, access should be left for servicing and maintenance. No costs relating to inadequate access can be accepted.

Care of the mixer

Our products are finished to the highest standard and due care needs to be taken to ensure their looks are retained.

We recommend cleaning all products with a soft damp cloth ONLY and advise strongly against the use of ALL cleaning products i.e. powders and liquids.

If the above instructions are not followed this will invalidate your guarantee in the event of a problem occurring.

Maintenance - handset

To remove any build up of limestone on the showerhead, just rub your fingers lightly over the nozzles.

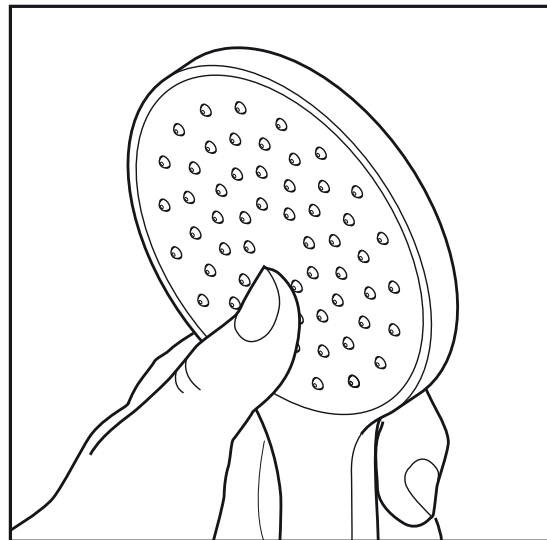

Important – Please Read

Installation

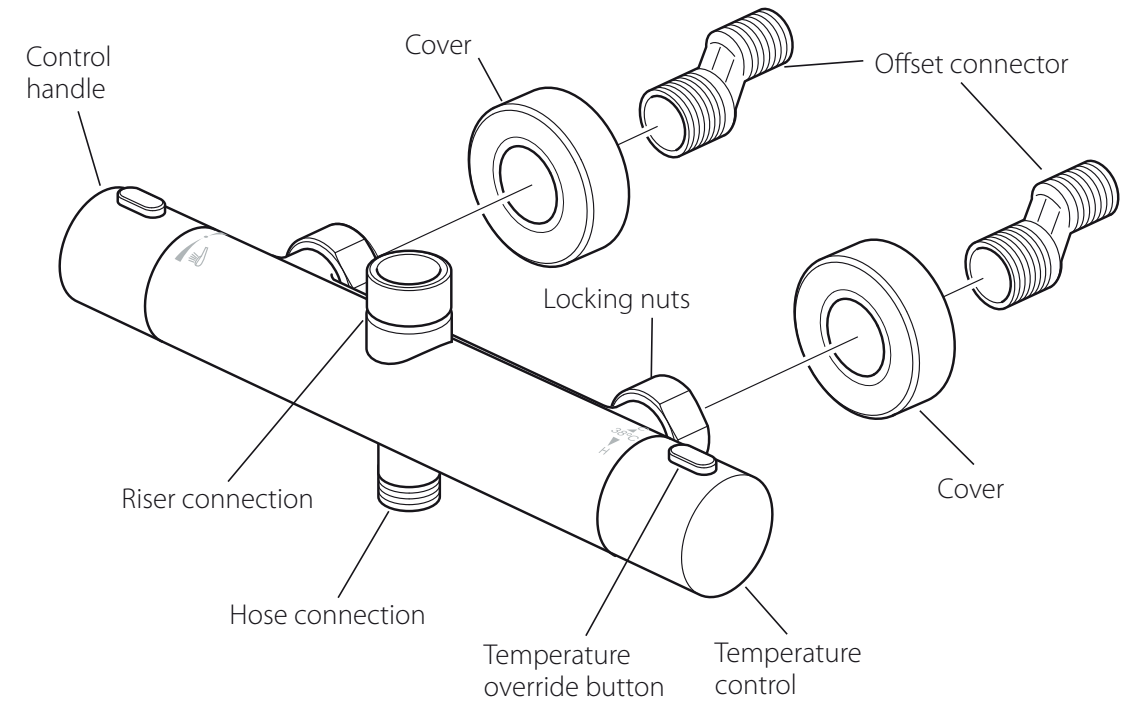

Before installing your new mixer, flush through the pipework to ensure removal of debris, turn off the water supply.

Prepare the wall with 2 flush ½" connectors at 150mm centres. Connect the water supply to the inlet pipes. The hot water should be connected to the left hand pipe. Screw on the 2 offset connectors followed by the covers.

Screw the locking nuts on the valve onto the connectors, some adjustment can be made to the offset connectors to align the centres and level up the valve.

Note: If you are installing this item using our fixing brackets (product code: WG-049BRACK+SHR-C/P) please ensure a ¾ fibre washer is used in addition to the mesh filter washers in the valve inlets in order to create a watertight seal.

Also due to the location of the NRVs (Non Return Valves) in the offset connector, when using the WG-049 Bracket and Shroud an additional NRV must be fitted in line to each of the hot and cold supplies.

Installation

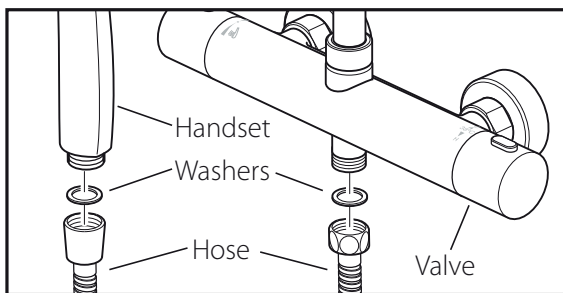
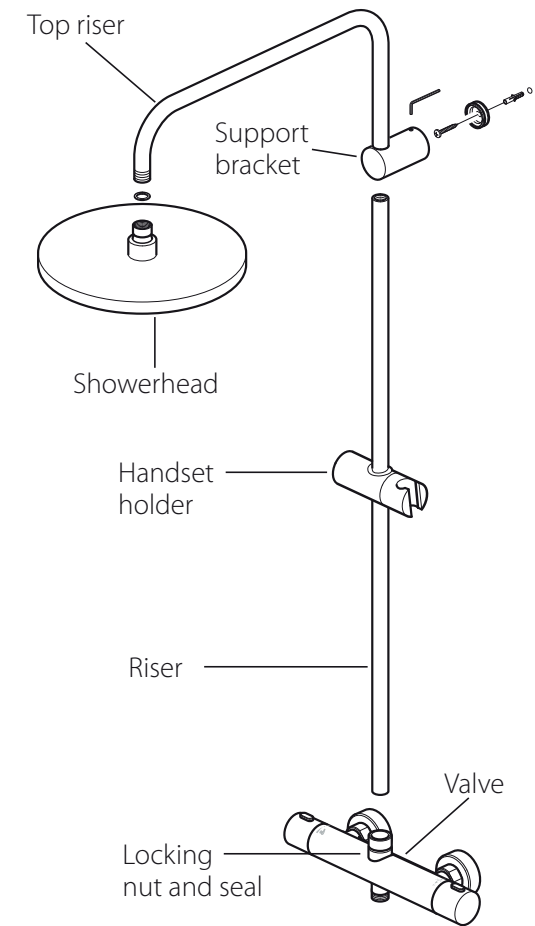
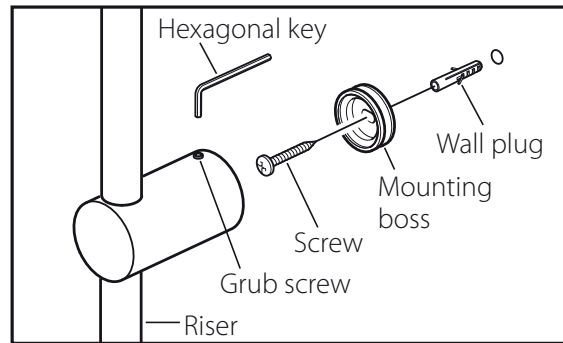

Warning! Please check for any hidden cables and pipes before drilling holes in the wall.

Screw together the riser and top riser. Remove the locking nut and seal from the valve, slide the locking nut onto the riser followed by the seal (tapered end last) push the riser into the valve, slide down the seal and nut and tighten to the valve, but do not tighten.

Using a level make sure the riser is vertical and mark the position of the support bracket onto the wall, remove the riser.

In the centre drill a 6mm hole 30mm deep for the wall plug and secure the mounting boss to the wall with the supplied screw (see inset left above).

Position the riser back onto the valve and push the support bracket over the boss, tighten the support bracket in position with the grub screw and tighten using the hexagonal key. Tighten the nut on the valve to secure it to the riser.

Finally place a rubber washer into the showerhead and screw onto the top riser. The angle of the showerhead can be adjusted as required.

Hose connection

Place one of the rubber washers into the cone end of the hose and screw to the handset.

Place the second rubber washer into the other end of the hose and attach it to the valve.

Temperature setting

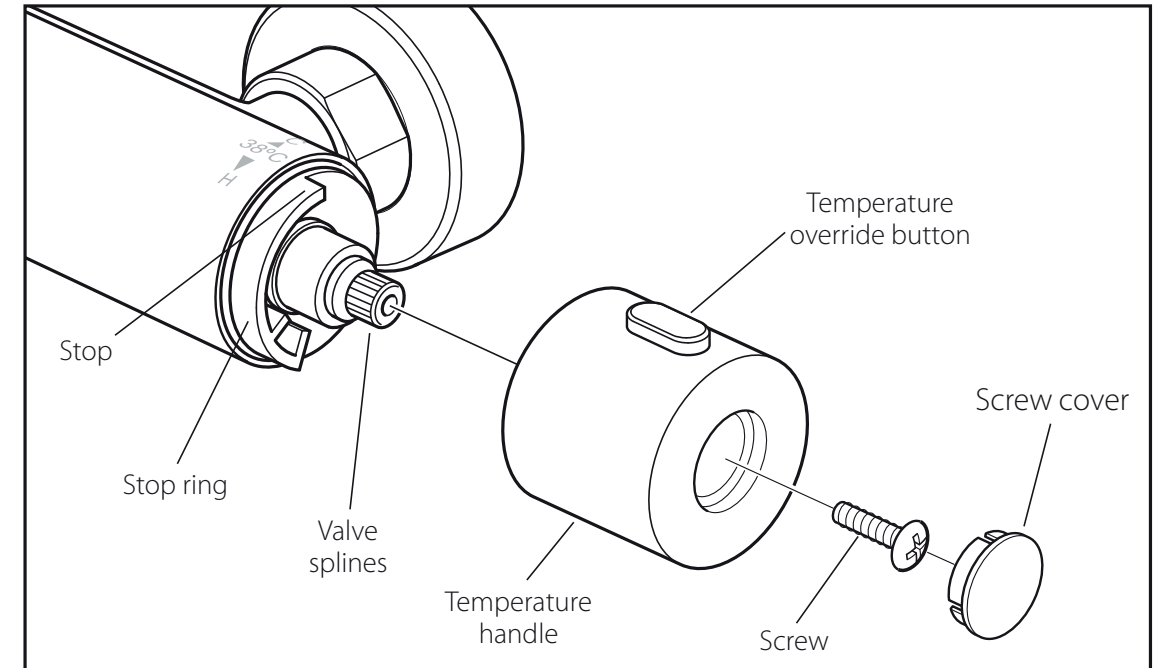

The valve has been factory set under balance pressures and hot water supply at 65° C. When your specific operating conditions are significantly different from the above, the temperature of the water may vary from the setting. When the difference is too great, you can adjust the calibration of the valve to suit individual requirements of the installation:

1. Select 38° C on the handle and check the temperature of the water being delivered to the outlet with a thermometer.
2. If the temperature is unacceptable proceed to reset the calibration as follows: Remove the handle by pulling out the screw cover, remove the screw from inside and pull off the handle (do not remove the stop ring). Turn the spline of the valve clockwise to decrease the temperature and anti-clockwise to increase the temperature until 38° is achieved.
3. Ensure that the stop on the stop ring is pointing at 12 o'clock, replace handle with the temperature override button pointing at 12 o'clock being careful not to turn the splines of the valve.
4. The valve setting is now calibrated to suit your requirements.

Operating Specifications

Hot Water Supply Temperature:
 Maximum: 85° C
 Minimum: 10° C higher than the maximum required mixed temperature (advise 65° C)

Operating Pressure:
 Minimum operating pressure 1.5 bar
 Maximum operating pressure 5 bar

Important – Please Read

Operation

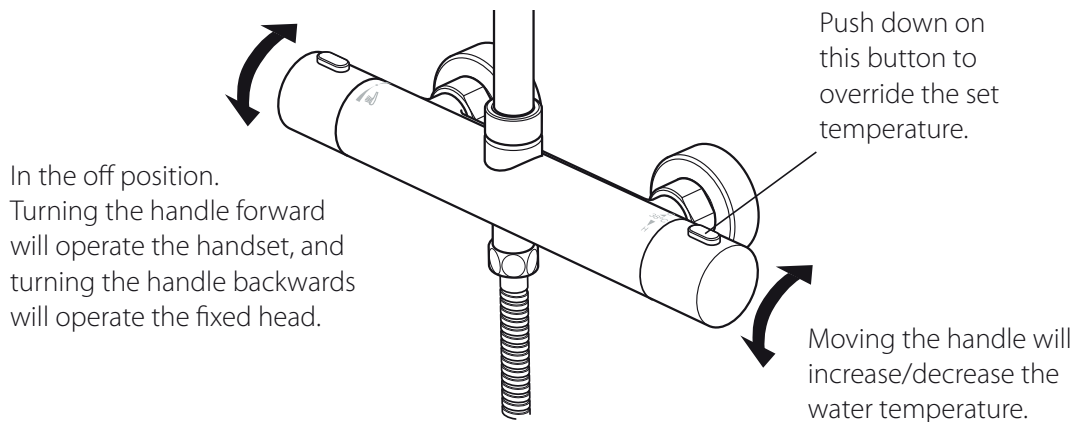

Maintenance

This thermostatic valve is fitted with a double filtering facility. Filters are fitted on the water inlets and on the thermostatic cartridge.

Depending on the water quality, filters may become dirty, causing reduced flow and inefficient working of the valve.

Shut off the water supply to both inlets at the isolating valves.

Inlet Filters.

Undo both locking nuts at the back of the valve and remove. Remove the filter, rinse in water to remove the dirt, and then soak them in vinegar or descaling agent.

Cartridge Filters

To clean the filters, you must first remove the cartridge from the housing.

1. Remove the handle by pulling out the screw cover, remove the screw from inside and pull off the handle.
2. Pull out the stop ring from the body (see page 6).
3. Unscrew the internal locking ring and pull out the cartridge.
4. Clean the filters by rinsing them in water to remove the dirt and soaking them in vinegar or descaling agent.
5. Before reassembling the cartridge, clean its housing with a wet cloth and grease the 'O' rings on the cartridge.
6. Push the cartridge into the body, replace the locking ring and tighten, push in the stop ring with the stop at the 12 o'clock position.
7. Make sure everything is tight and secure and turn on the water supply at the isolating valves.
8. Now check the water temperature to ensure that it is re-calibrated to 38°C.
9. With the temperature override button at the front, push in the button and push the handle onto the splines, being careful not to turn the splines of the valve.
10. Secure the handle.